



BASICPOLE

standard composite lighting column
safety and economy above all

Composite columns are CE certified to comply with European standards EN 40-7 and they meet the requirements of EN 12767. The company also received positive feedback of the Railway Institute in Warsaw and can be used on Polish railways.

alumast S.A.
design a safer world

ECONOMIC AND SAFE ROAD WITH COMPOSITE LIGHTING COLUMNS STARTING FROM PURCHASE UNTIL DISPOSAL

PURCHASE



NEW POSSIBILITIES

Columns can be produced in any colour according to RAL palette or with a customised pattern and internal illumination (DESIGNPOLE line).

You can create your own design (texts, logo, symbols etc.)

Pattern is an integral part of the column and it is resistant to scratches and damages.



Birch

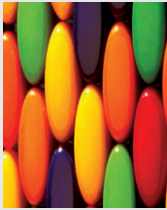

Candy



Wood



Clover

Composite lighting columns do not cause any interferences for radio waves, microwaves, radars and others. What is more, there is no dew point so columns are perfect solution for radio transmitters (for example 5G network) and for other devices installed inside.

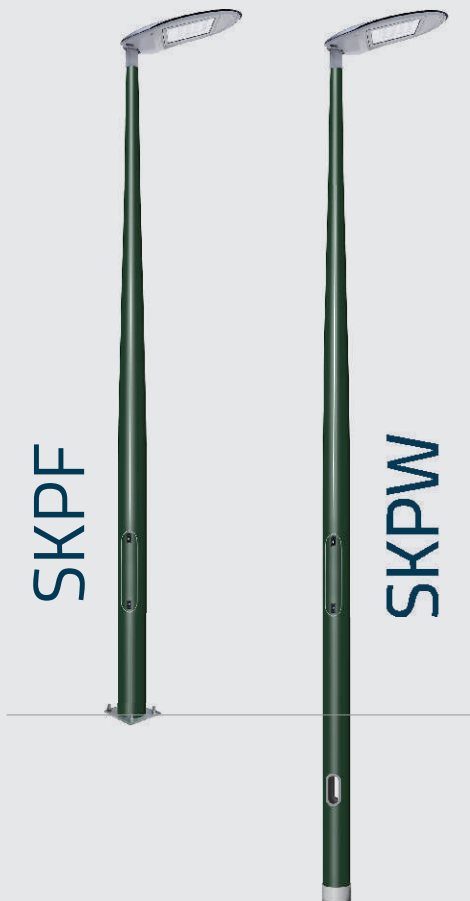

TRANSPORT AND ASSEMBLY



SAVING AND SAFETY

1 lorry = 200 columns

9m lighting column mounted in the ground weighs 59 kg.



Additional savings when you choose columns mounted in the ground:

- no steel base or foundation
- no need for heavy assembly equipment
- lower transport cost and the assembly
- no need to be earthed, no control measurements



10 years warranty for composite columns mounted in the ground

ECONOMIC AND SAFE ROAD WITH COMPOSITE LIGHTING COLUMNS STARTING FROM PURCHASE UNTIL DISPOSAL

USAGE



NO ADDITIONAL COSTS

the lifetime of composite column is 40 lat

Columns are UV resistant. Smooth surface allows easily removing dirt or remains of glue and Scotch tape used for hanging commercial advertisement and posters.



Glass - polyester composite in an insulating material. Even while damaging the insulation of wires, soaking or vandalizing, on the surface of composite column a dangerous voltage will not appear.



Composite columns PASSIVEPOLES were tested for EN 12767 norm „Passive safety of support structures for road equipment - requirements and test methods“. The composite column slightly absorbs the energy during a collision - after the collision the vehicle is continuing the ride with a reduced speed.



Composite access doors are valueless at the metal return points. It eliminates the problem of stealing and limits a vandalism and the costs of service.

Composite column is resistant to rusting. What is more, it is resistant to:

- salt on the roads and other road cleaning agents
- traffic pollution
- animal waste
- acids and alkalis

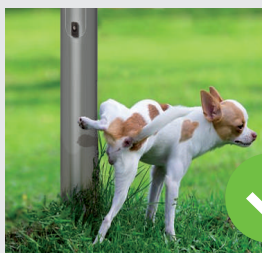

ECOLOGY



Production of composite lighting columns is eco - friendly because of low CO2 emission. Energy used during transportation is smaller due to low weight of the column.

The graph shows the environmental impact [mPe] of different types of poles in two environmental categories (assuming that the service life will be 50 years for all products)

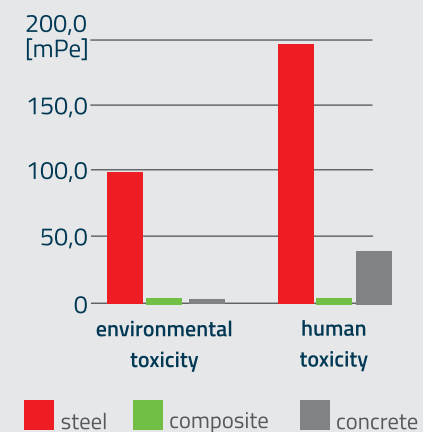

Source: Swedish Environmental Research Institute, report: „Comparison of the environmental impact of poles made from different material“

DISPOSAL



The composite lighting column is 100% recyclable - product is eco - friendly

we dispose columns at our expense after the operation period - you deliver the column and we do the rest.

CONFIRMED STRENGTH OF COMPOSITE COLUMNS



see tests on our channel

youtube.com/alumast

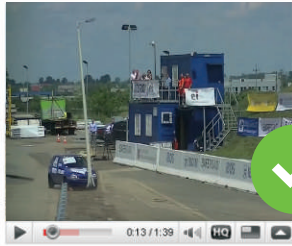

CRASH TEST

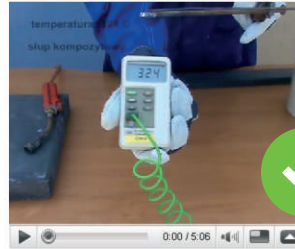

FLAMMABILITY TEST



VANDALISM TEST

AREAS OF APPLICATION



ROADS



RAILWAY



ENERGETICS



INFRASTRUCTURE
OF LOCAL
GOVERNMENT UNITS



DEVELOPERS



COMMERCIAL
BUILDINGS



RECREATIONAL
FACILITIES



HoReCa



FUEL STATIONS



OTHERS

SELECTED PROJECTS



BIELSKO-BIAŁA



RYDUŁTOWY

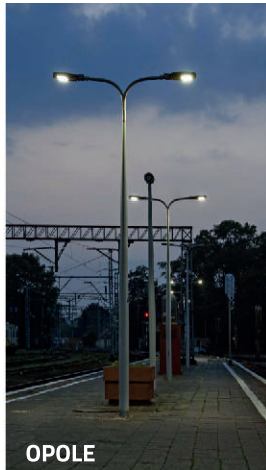

OPOLE



KOLBUDY

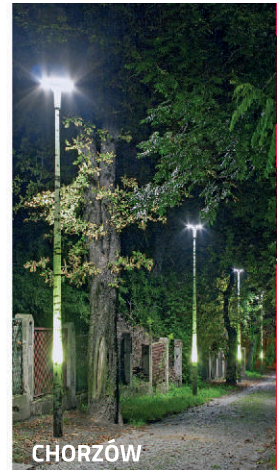

CHORZÓW

Make your investment smart!

Our offer includes highly developed lighting column SMARTPOLE which does not have to be just a construction supporting a luminaire. It is an innovative product designed to improve safety and comfort.



Additional possibilities:

- charger for electric cars and bikes
- wireless Internet access (Wi - Fi)
- wireless inductive charging of portable devices
- bluetooth speaker
- electric socket
- USB port
- video monitoring
- gathering anonymous data on traffic
- the ability to configure additional solutions in accordance with the project requirements

the possibility of using wind and solar energy



DIMENSIONS OF COMPOSITE COLUMNS

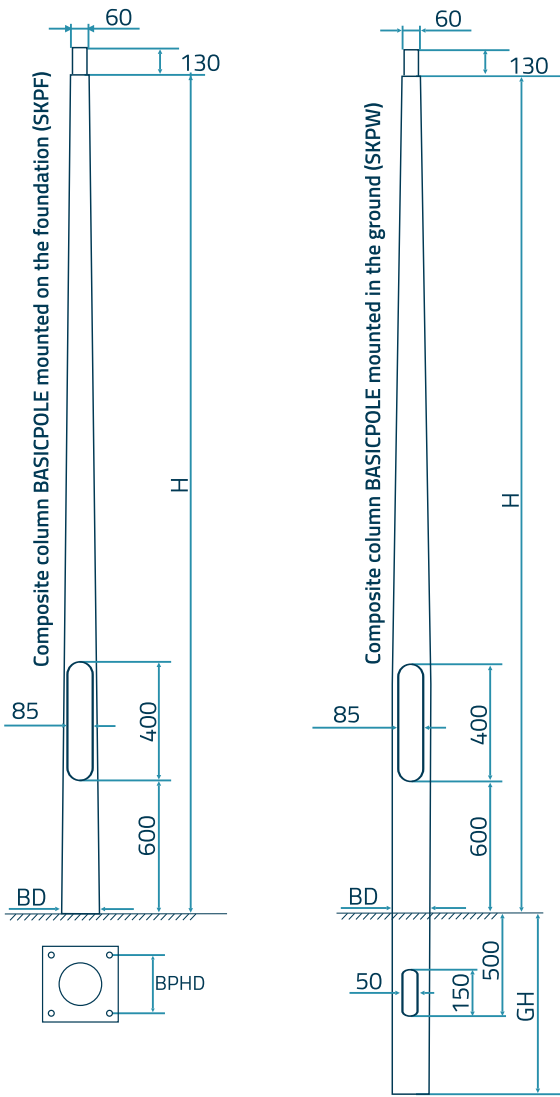

SKPF				SKPW	
height H (m)	BD (mm)	BPHD (mm)	Weight (kg)	GH (m)	Weight (kg)
3,0	150	200	15	1,0	10
4,0	150	200	18	1,0	12
5,0	175	200	24	1,0	19
6,0	175	200	26	1,0	22
7,0	193	300	55	1,2	40
8,0	193	300	60	1,2	50
9,0	193	300	70	1,5	59
10,0	193	300	75	1,8	65
11,0	193	300	80		
12,0	193	300	85		

CONSTRUCTION:

GLASS FIBER WITH POLYESTER RESIN

GLASS FIBER WITH POLYESTER RESIN

GLASS MAT WITH POLYESTER RESIN

GELCOAT

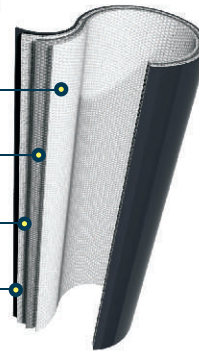

STANDARD COLOURS INCLUDED IN THE OFFER

RAL 7032 RAL 7042



the possibility to choosing any colour from RAL palette

ADDITIONAL ACCESSORIES

ALUMINIUM BRACKETS

single arm, double arm, three-armed, four-armed

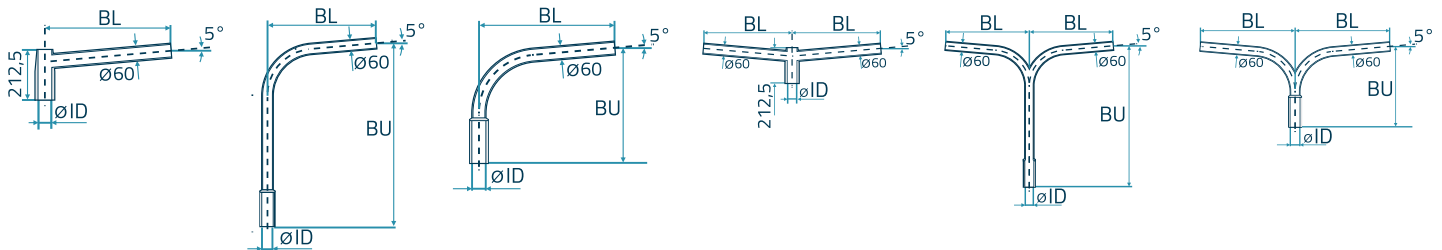

BL [mm] - bracket arm length: 500 - 1500 mm

BU [mm] - bracket height: 0,5m or 1m

FOUNDATION

precast concrete foundations

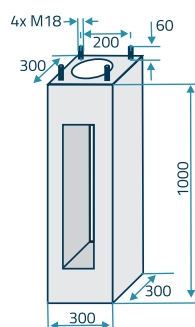

F100/30

for lighting columns with bolt spacing 200x200mm (bolts and nuts in set)

kg = 115kg

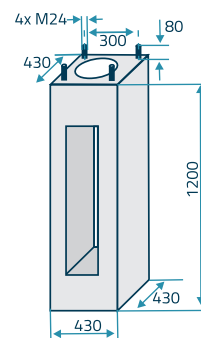

F120/43

for lighting columns with bolt spacing 300x300mm (bolts and nuts in set)

kg = 311kg

ABOUT US

As a leading designer, we produce composite and aluminum lighting and construction solutions.

We constantly care about technological development as well as improving the quality of our products.

Our research facilities, close cooperation with scientific centers partnerships with experienced entities from the design industry allow us to constantly improve the strength and resistance parameters of polymer composite structures.

With over 20 years of experience, we constantly look for new composite applications, ensuring that the properties of this material are used more in the energy and railway industries, and also the road and advertising infrastructure.

POLISH PRODUCT



OTHER PRODUCTS AVAILABLE IN OUR OFFER

all columns can be also produced in version mounted in the ground

TWIXPOLE

composite - aluminium column

STORMPOLE

composite lightning protection mast

SMARTPOLE MULTI

multimedia composite column

SMARTPOLE CROSSING

active column for pedestrian crossings

DECORPOLE

stylized composite column

DESIGNPOLE

column with a pattern and internal illumination

TELETECHNICAL

composite telecommunication pole

EASYPOLE STANDARD

column with hinged mechanism

EASYPOLE PREMIUM

FLAGPOLES

composite and aluminium flagpoles



Please contact us if you have any questions.

We will be happy to prepare an offer adjusted to your needs.

alumast S.A.

ALUMAST S.A.
Markłowska 30A
44-300 Wodzisław Śląski
tel. +48 32 453 03 14
info@alumast.eu
www.alumast.eu